

Proudly brought to you by:



PO Box 5658 Brendale
QLD Australia 4500
Customer Support
1800 812 261
www.crest.com.au

AUSTRALIAN OWNED 1488

1 SELECT

UP TO 20km
DISTANCE TO TV TOWER



SELECT THE RIGHT ANTENNA
FOR YOUR LOCATION:
www.crest.com.au/myantenna

HD

READY



TESTED IN
AUSTRALIA

1 SELECT

2 INSTALL

3 RE-TUNE

Power Boost
with Mains Adaptor

Adjustable Loop & Antenna Rods

Fine Tune
Adjustable Signal Strength

SGA05328

Indoor Digital TV Antenna

Power Boosted

SPECIFICATIONS

Frequency Range: VHF: 87.5-230MHz UHF: 470-862MHz

Impedance: 75Ω

Receiving Range: FM/VHF/UHF

Gain: 30dB

Power Supply: Via AC/DC adaptor (DC12V/50mA)

Contents

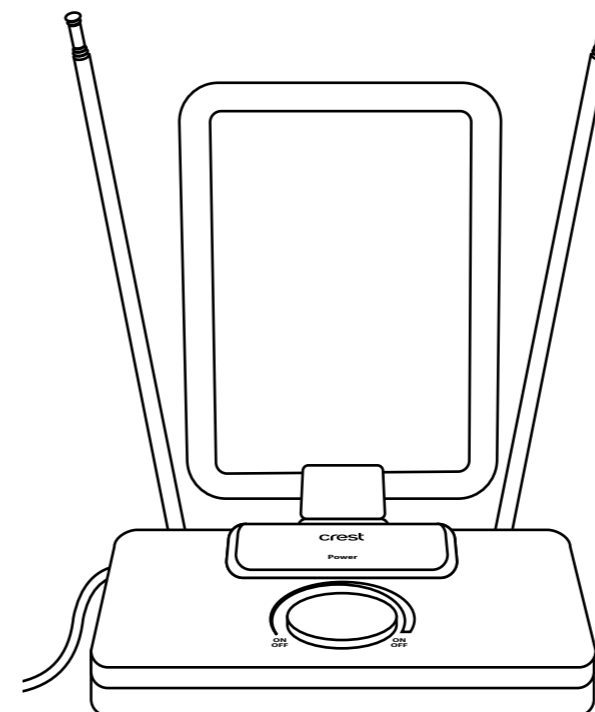

A: Antenna Unit with Cable

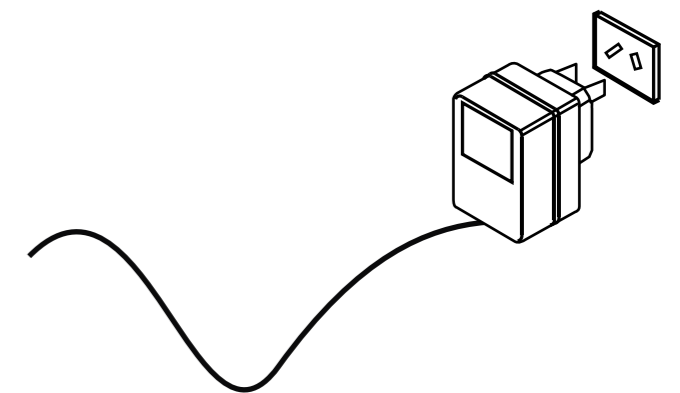

B: Power Adaptor

crest

2 INSTALL

- Connect the antenna cable to the antenna input socket on your Digital TV or Digital Set Top Box.
- Plug the power adaptor into the mains and connect to the antenna via the power input socket.
- Turn the control knob clockwise to turn on. The LED will light up indicating the power is on.
- Set the control knob to a high position to increase the signal gain strength if you are far away from the transmission tower. Set the control knob to a low position to reduce the signal gain strength if you are close to the transmission tower.

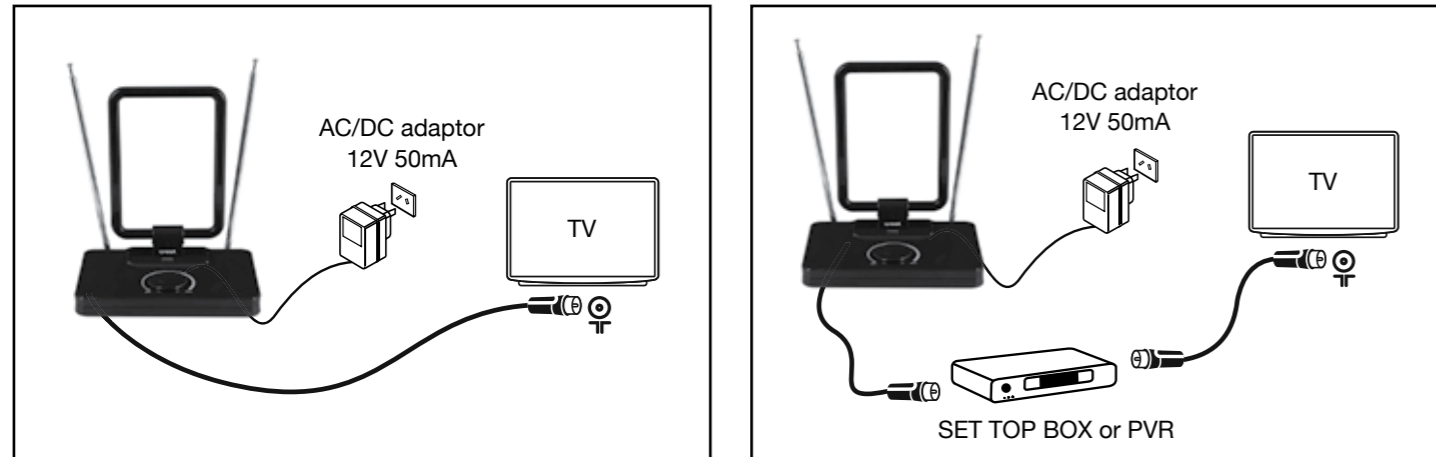

- Point antenna in the direction of the nearest TV transmission tower. (visit www.crest.com.au/myantenna to identify the location of the nearest TV tower to your location).



- ⚠ Place the antenna away from electrical sources of interference such as air conditioners, computers, gaming consoles and high powered kitchen appliances like microwave ovens. Do not place on top of your TV.**

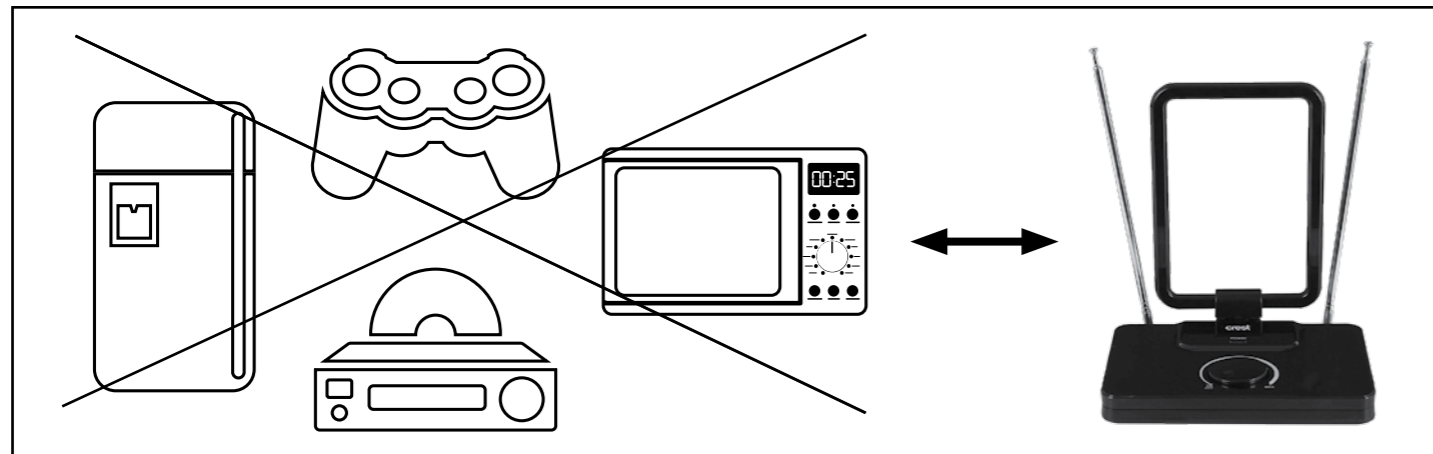

3 RE-TUNE

Re-tune your TV following the instructions in your TV manual.

- <http://www.lg.com/au>
- <http://www.samsung.com/au>
- <http://www.sony.com.au>
- <http://www.panasonic.com/au>

Trouble shooting guide

ISSUE	ACTION (After re-positioning or adjusting your antenna you should re-tune your TV)
No picture or sound, or picture is pixelated.	<ul style="list-style-type: none"> • Ensure you have selected an antenna appropriate for your location. Visit www.crest.com.au/myantenna for assistance. • Try moving the antenna to another place in the room. Placing near a window often works well especially if you can point towards the TV transmission tower. • Make sure the antenna is away from any electrical appliances. • Adjust the rods and loop of the antenna for optimal reception. • Adjust the control knob anticlockwise to reduce gain strength and adjust clockwise to increase gain strength. • If you live more than 10kms from a transmission tower make sure the antenna is plugged in and mains power is on. You may need to set the control knob to high position to increase signal strength. Experiment with the different control knob settings. • If you live within 0-10kms away from a transmission tower you may need to turn your control knob to low or turn off the power to the antenna completely. The antenna may still receive signal even if the mains power is switched off when it is close to the TV transmission source.
I can only receive a few channels.	<ul style="list-style-type: none"> • Please refer to steps above. Experimentation is often required to find an optimal location and orientation. With indoor antennas, you may find that an antenna may not receive all available channels at one location or orientation.
I've tried all the steps above, but have not solved my problem.	<ul style="list-style-type: none"> • The reception performance of an indoor antenna can vary based on factors such as the materials with which your home is constructed and obstructions outside of your home such as hills, valleys and other buildings. It may be that an outdoor antenna is required for your particular circumstances. • When all TV was broadcast as an analogue signal, a weak signal could still give you a watchable result even if it was a bit grainy. The way in which a digital signal works is different. Instead of the picture becoming less clear as the signal strength reduces, a digital signal will simply stop showing any picture at all. With digital signals, picture quality is all-or-nothing. • Call our team on 1800 812 261 and we may be able to recommend the right antenna solution for your location.